



IMANI COLLECTIVE

Addressing generational poverty across Kenya.
Access to Dignified Work | Well-Being Working Culture



TIMELINE + MISSION



To empower and create change to break down the generational cycle of poverty through training, self-development mentorship workshops, access to dignified work, and by instilling a supportive well-being space for our artisans to dream for a brighter future

LOCATIONS

MTPENI VILLAGE, KENYA
OLD TOWN, KENYA
TURKANA, KENYA
DIANI, KENYA

OVERVIEW

the objective

By bringing our model to the poorest region of Kenya, we hope to provide 40 individuals with a dedicated safe, and secure working space, equipped with essential amenities. These individuals will gain access to dignified work, socio-economic stability, and upward mobility out of generational poverty.

the problem

Imani Collective currently operates out of a church in Turkana limiting our ability to run at full capacity. The space is small, dark, and hot to wear most of our artisans prefer to sit outside underneath the trees. Renting a space has also made it difficult to provide the best care for our artisan's and their families.

the opportunity

The first phase of our construction will lay the foundation for holistic growth in Turkana. It will broaden the boundaries of the Turkana location, create the first artisan workshop, and provide for basic needs of families in Turkana. Our long-term goal is to create a conference center and guest housing for NGO's to have a place to stay as they come in to help uplift the Turkana people.



WHY US?

For more than 8 years as a nonprofit, we have organically learned and identified gaps in traditional models of workforce development. This experience has been fundamental in the expansion of our operations which results in the creation of more jobs throughout Kenya.

2021 IMPACT AT A GLANCE

131	JOB CREATED
3	LOCATIONS
24	CHILDREN IN OUR IN-HOUSE CHILDCARE
1,200	HOURS OF TRAINING PER ARTISAN
34,000	MEALS SERVED IN 2021

Turkana Land Development Summary

80 jobs created

100+ families to be impacted

Weekly food distribution for the local community

Total cost of project = \$244,500

1st year start-up cost = \$38,500

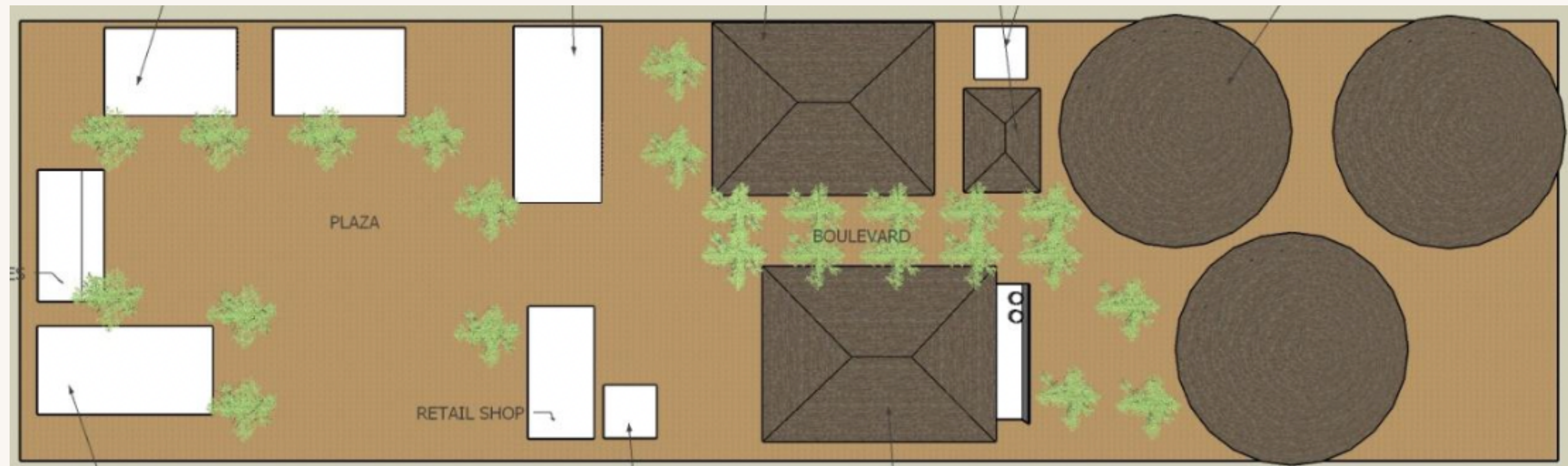

Phase 1: Building Plans

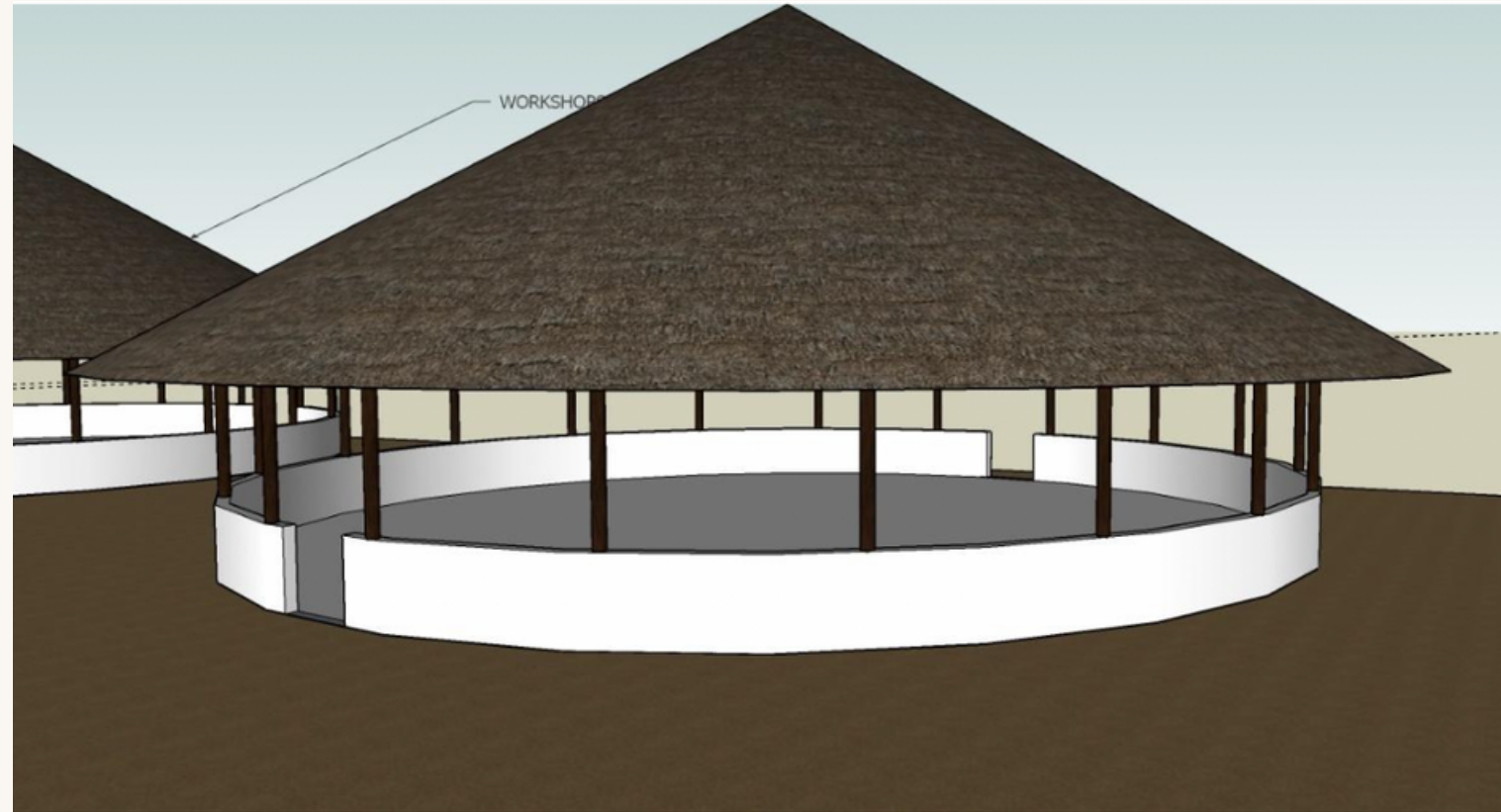

workshop

Our workshop structures are designed to maximize airflow while also protecting each artisan from the sun.

Maximum: 3 structures

Capacity: 22 workstations per structure

Creates space for 80 new jobs

childcare facility

With two rooms and a covered open play area for the kiddos; the children will have a safe environment to grow and learn.

Maximum: 1 structure

Space for 16 children and 2 staff member



Phase 1: Building Plans Cont.

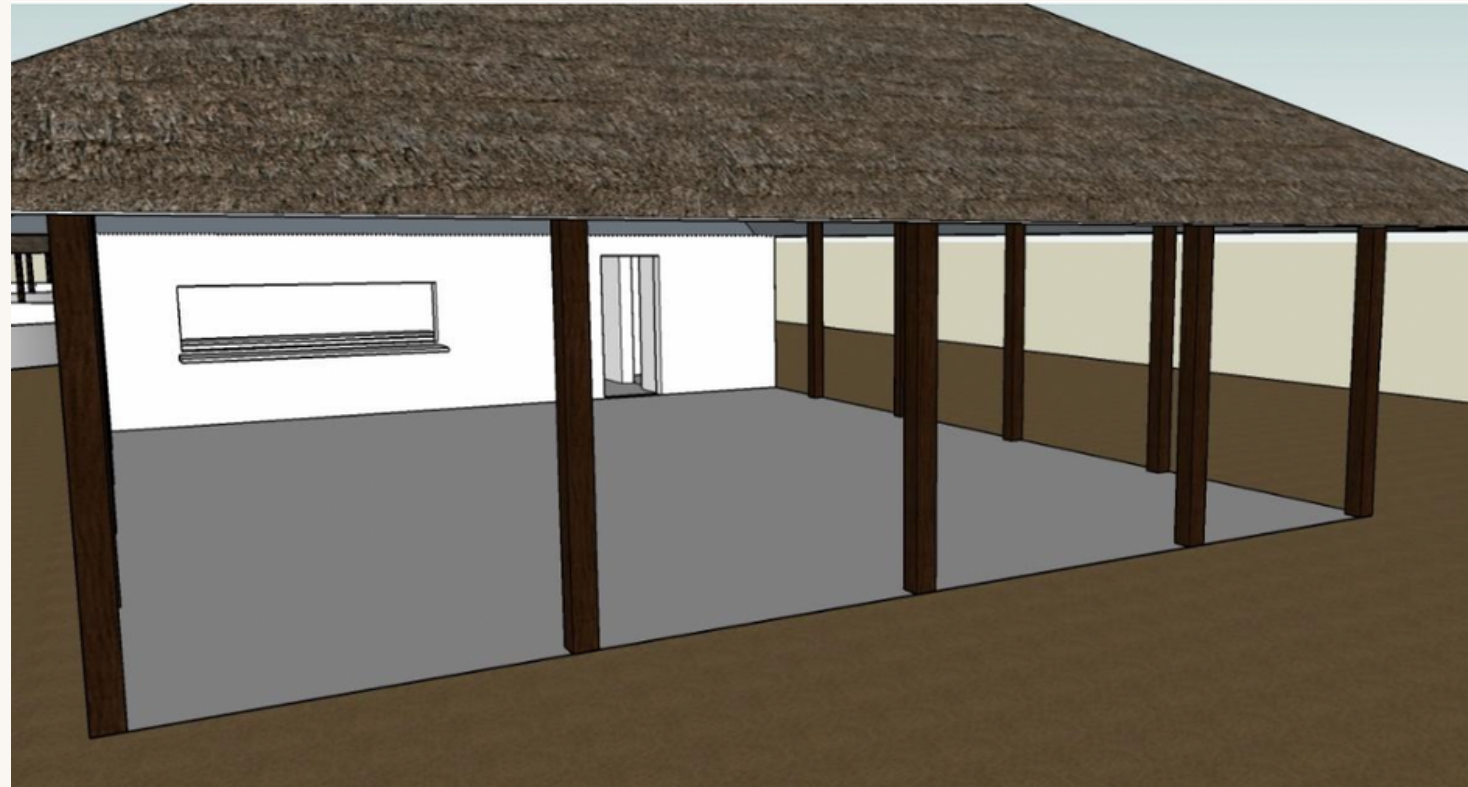

food center

One structure to store manna packs for the community, open ventilation on the backside for cooking daily meals for the artisans, and a covered area for everyone to enjoy their meals under.

Maximum: 1 structure

Capacity: Food supply for local communities and daily meals for artisans, staff, and children

Feeds 80+ artisans, staff, and children

bathrooms

These bathrooms will come fully equipped with running water and a handwashing station to ensure healthy hygiene in our community.

Maximum: 1 structure

Size: 6 stalls

for the use of men, women, and children

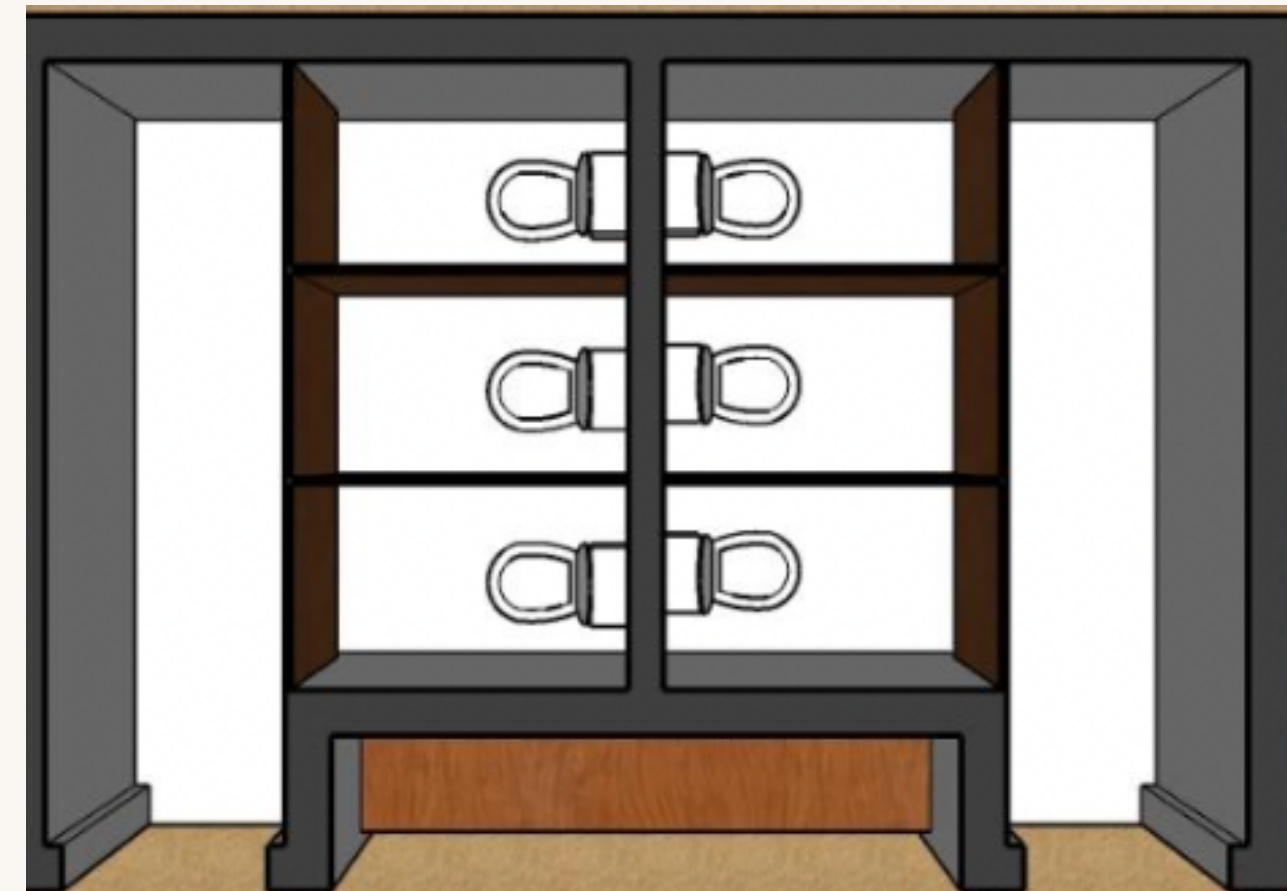

TRANSFORMATIONAL STORY

We believe in investing in our artisans, but we also believe in them investing in themselves and their community.



Mariam Echwa Etheke

For Mariam Echwa Etheke, life before joining Imani Collective was very hard and during those desperate times, being a 65 yr old widow, she had to work tirelessly looking for reeds to make brooms to sell in order to be able to provide at least one meal a day for her family.

This is no longer her story after joining Imani Collective as she is now able to easefully put food on the table and pay her children's school fees with no worries attached. Last year, she started a side business selling cereals to your community on the weekends and was even able to rebuild her house! She even confesses to adding weight which is highly welcomed and praised.

Turkana Development: Phase 1

Phase 1	Cost	Estimated implementation
13 Acre Land Purchase	\$28,000	Upon receiving financial funding, it will take around five months for phase one to be completed.
3 Workshop structures built	\$1,000	
1 Office building built	\$2,000	
Perimeter fence and tree planting	\$2,500	
Electricity connection	\$5,000	
Water connection/drilling	\$5,000	
Total:	\$38,500	

Turkana Development: Phase 2 - Phase 4

Phase 2

Architectural drawings and
development of design
landscaping

Cost: \$26,000

Phase 3

Building of permanent
workshop, office block
and Holistic centre

Cost: \$80,000

Phase 4

Building of Cultural Center
Building of Guest Housing
Building of Conference
Center

Cost: \$100,000

Total Goal: \$206,000



OUR ASK

\$39K

Create more impact together

- + 13 ACRE LAND PURCHASE
- + 3 WORKSHOP STRUCTURES
- + ELECTRICITY AND WATER CONNECTIONS
- + AND MORE



Ways to Give

Donate by Check

Make checks payable to Imani Collective. If you're donating in honor of someone, sponsoring a specific project, or want to direct your donation to our operating costs, please write that in the memo of your check.

Bank Transfers

Imani Collective has the capability to use Zelle®. It is a fast, easy and convenient way to send money using banks, such as Bank of America, Wells Fargo, and U.S. Bank. Email partnerships@imanicollective.com for more information.



Imani Collective 4653 Nall Rd Farmers Branch, TX 75244

Imani Collective is a 501(c)(3)

The background is a light cream color with several abstract, organic shapes in muted colors. In the top left, there is a dark olive green wavy line. In the top right, there is a small purple cloud-like shape. In the center right, there is a large, light beige circle. In the bottom left, there is a dark olive green shape. In the bottom center, there is a brown arch. In the bottom right, there is a purple shape. The text "THANK YOU!" is centered in a bold, brown, sans-serif font.

THANK YOU!