



Build a School for Next Generation Leaders

Proposal by Milaan Foundation

Project Context

India has a positive demographic opportunity, with half of its population in the working-age group. According to census 2011, **1 in 4 children of school-going age are out of school in our country – 99 million children in total have dropped out of school.** Needless to say, education is a tool required to realise this demographic potential. Along with childhood nutrition, safe space and good mentoring, quality schooling forms the basis of ensuring all-round development of a person.

Poor employability is a direct outcome of poor education. With 70% of India's workforce residing in rural areas, it is rural India that will form the majority of tomorrow's workforce—half of the total population is expected to be in rural India by 2050 (according to NITI Aayog). Even though the number of rural students attending schools is rising, the pitiful condition of school infrastructure, lack of textbooks, classrooms and declining teachers are leading to poor learning outcomes and development as stated in a survey called the Annual Status of Education Report (ASER).

Every single one of these children has the right to a safe creative learning space, secure education that “develops their personality, talents and abilities to the fullest” (UN Rights of the Child), enriching their lives now and laying the foundation for a brighter future – for both themselves and their communities.”

Need

Uttar Pradesh is the most populous state of India with 200 million people. Milaan's Swarachna School, in the heart of rural Uttar Pradesh has been providing education for 12 years to children from socially and economically challenged communities catering to 13 villages. For the last 5 years we have had 100% results in both 10th and 12th, a feat we are extremely proud of given the context of education in UP.

For Milaan, running a school in a remote rural village is not just a channel for traditional education, The school also transcends the mental boundaries of an educational institute and becomes a space for children to unleash their creativity, access a creative learning space and various mediums for exposure to enhance their learning abilities to enriches their lives now, and opens opportunities for their future.

As we evolve and move into our next phase of growth there are two needs we need your help to address.

1. Primary Education

The first need is that our primary section is getting cramped as more in-need children arise each year. Having to turn them away due to shortage of space doesn't feel right. Looking at the rising need we want to build a separate primary wing, so that we do not have to turn away a single child who deserves education.

According to Ministry of Panchayati Raj, GOI, **Sitapur, UP is one of the most backward districts of India** with the Sex Ratio of 789 female per 1000 male according to 2015–2016 National Family Health Survey (NFHS-4). The average literacy rate of Sitapur district is 61%, significantly lower than the national average of 74.04% with female literacy at only 50%. The annual district per capita income is less than INR 5000 a month, among the lowest in the country. Clearly there is an urgent need to be addressed.

The Swarachna School is in block Sidhauri of Sitapur district of Uttar Pradesh. Its student demographic comprises 78% from the Dalit community and 84% come from below poverty line families. It is one of only two secondary schools in a radius of 13 km.

Building a primary education infrastructure will address all of these needs.

2. High Dropout rate among Adolescent Girls

The second need addresses adolescent girls, who are high performing and academically gifted, but dropout after class 8 because of economic and social reasons.

A report by the ministry of statistics and program implementation reveals that after class 8th the dropout rises sharply particularly for girls. Poverty, early marriage and restricted mobility are some of the contributing factors for girls dropping out of secondary education.

Uttar Pradesh has amongst the highest rates of dropout after secondary education. The NCPCR report states that around 39.4 percent of adolescent girls in the 15-18 age group are not attending any educational institution, and a vast majority – around 65 percent – of them are "either engaged in household activities, are dependents, or, are engaged in begging, etc".

Focusing on building a residential campus especially for adolescent girls (grade 9th to 12th) will enable us to change this narrative in the communities that we serve, creating generational change and pull hundreds out of poverty.

Specific Objectives

- Create quality learning opportunities for children from challenged background.
- Increase school enrolment rate in Uttar Pradesh.
- Decrease the school dropout rate, especially amongst adolescent girls.
- Minimize gender disparity in education.
- Build the spirit of community service and good citizenship among future generations.
- Promote nutrition, well-being, awareness and gender equality through quality education.
- Contribute to the fulfilment of India's commitment to the United Nations SDGs 3, 4 and 5.

THE SOLUTION



Quality of education depends on infrastructure such as classrooms, water and sanitation facilities, availability of electricity, provision for digital learning, sports facilities and softer elements such as presence of school staff, professionally competent teachers, access to books and learning materials, among others.

Block A – PRIMARY SCHOOL

Total Built-up Area – 26598 Sqft



Existing School Building



New Primary Block (Block A)

For the first need, our solution is to create a dedicated 26,598 Sq. Ft. co-ed primary school for 500 students from lower kindergarten to grade 5th. This will include classrooms, washrooms, staff rooms, Labs, Library and Play areas including furnishings.

BLOCK B Girl Icon Leadership Academy

Total Built-up Area – 18942 Sqft



Phase 1 : Extension of Secondary Block



Phase 2 : Addition of One floor above the Secondary Block

To address high dropout rates amongst adolescent girls our solution is a world class facility to work with 320 adolescent girls to be named the Girl Icon Leadership Academy.

Milaan intends to create a residential setup for 320 high performing girls, where the girls can continue their studies after class 8th under the guidance of skilled teachers and a curriculum that has an equal focus on building leadership as on academic achievement. This will impact both Girls' education and empowerment.

The act of residing together beyond classroom hours has significant implications for management, living environment, relationships and learning. Residential schooling are more effective in reaching the most needy girls who then have access to all the facilities and services.

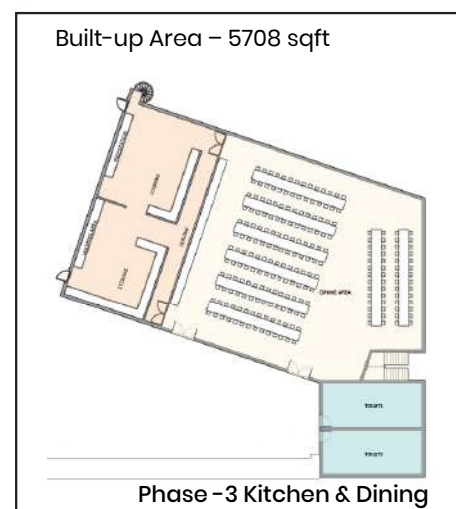

The residential facility would include dorms, staff quarters, Kitchen and dining. We aim to construct an eco-friendly campus of 18942 sq. ft. total, for the Girl Icon Leadership Academy.

The Impact

500 more children will get access to quality education at the primary level. Currently there are far more children from challenging backgrounds who want to join the school but we are unable to accommodate them. The government schools are the only options left. Unfortunately the learning outcomes of the govt. schools are not good enough to enable these children to break the shackles of poverty on their own merit. The primary school will contribute towards ensuring every child from these communities receives the education that is the right of every child.

Your support will also contribute towards creating a vibrant space 320 bright, capable and deserving adolescent girls from the most in need backgrounds, where they will develop their innate potential to be future leaders and changemakers. They will access leadership focused, quality education empowering them to take better decisions affecting their lives, become role models and agents of change in their communities.

Technology driven learning outcomes

In Today's world use of technology is unavoidable, Education that does not teach students how to harness the power of technology to be more efficient and effective is incomplete.

Methods used within the classroom will leverage technology in a positive and constructive manner. A curriculum that appreciates the power of technology in the learning process can serve to increase engagement in the classroom and make learning easier and more efficient.

We aim to build two dedicated technology based classrooms to further enhance learning outcomes. By using audio and visual materials, we can capture practical aspect of the theory taught in class. Having access to information outside of the book gives students many different ways to learn a concept. Teachers can come up with creative ways to teach their students that keeps them engaged.

Technology is therefore both a tool and a catalyst for change.

The Ask

1 Sqft OF HAPPINESS = INR 1100 | \$15 USD

Primary – 26598 Sqft X 1100 per Sqft is 2.92 Cr.

Girl Icon Leadership academy – 18942 Sqft X 1100 per Sqft is 2 Cr.

Kitchen, dining & Staff Residences – 10796 Sqft X 1100 Per Sqft is 1.2 Cr.

Total Construction – 56336 Sqft X 1100 Per Sqft is 6.2 Cr.

About Milaan Foundation

Milaan Foundation is a registered non-profit organization founded in 2007. We envision an inclusive and equal world, where every child has the knowledge, skills, and social environment to explore their full potential. Over the last 12 years, Milaan has worked with more than 35,000 children and young people, and advocated for safer and more inclusive spaces for them at various state and national platforms.

Milaan Foundation is a registered charitable organization as Milaan - Be the Change (NGO) with Registrar of Societies, New Delhi under the Societies Registration Act of 1860 as on 18th October 2007. The organization is also registered under 12A, 80G under Income Act Tax 1961 and is eligible to receive foreign donations under Foreign Contribution Regulation Act with Ministry of Home Affairs, Government of India. Milaan Foundation is a registered 501(c)3 based in Chicago.

Contact details

Tina Kapoor
(Communications & Partnerships)
tina@milaanfoundation.org
+91 837 601 7470

Dhirendra Pratap Singh
(CEO & Co-founder)
dhirendra@milaanfoundation.org
+91 995 628 0999

Sharadindu Goswami
(General Secretary & Co-founder)
sharatgoswami@milaan.in
+91 757 207 6488

Our Partners

