

Concrete Block Wall for Kenosis Community Foster Village

Design of Wall (Top down view of a typical section of the wall)

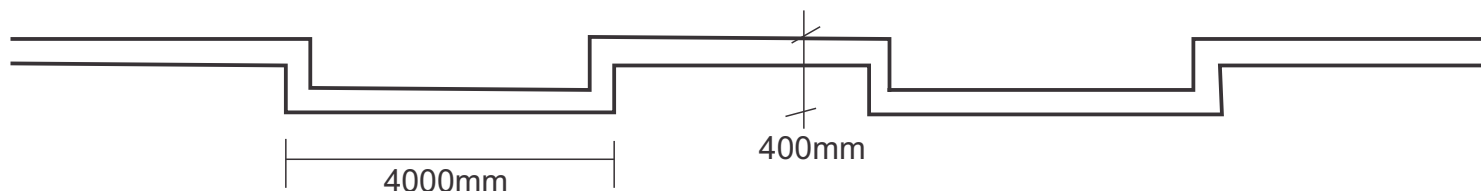

Cross Section of Wall and Foundation

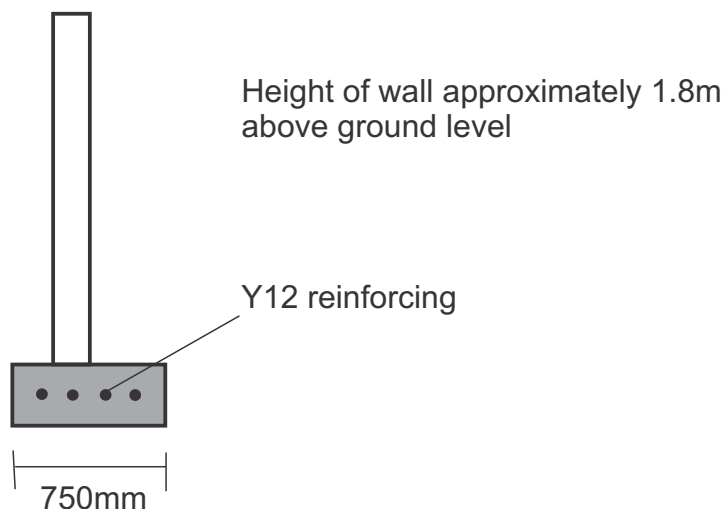

Specifications for the Security wall

Wall to be 1.8m high with a 750mm x 250mm deep foundation.
There will be 3 pedestrian gates and one vehicle access gate.
Construction will be out of M140 concrete blocks
20mpa concrete vibrated into trenches for foundations
Foundations will be dug in a straight line and will accommodate for the staggered wall.
Brick force will be used between every course
6:1 mortar mix to be used
Expansion joints every 2nd section linked with 6mm round bar.
Bag washed finish
There will be 10 or 11 courses of brick from top of foundation which will give a wall of about 1.8m high

The wall will be built using some of our older boys (who have left school. This will be done under the supervision of a skilled builder and will provide skills training for the boys).