

WATER AND SANITATION – TOILET COMPLEX CONSTRUCTION

| SECTION 1: General Information | |
|---------------------------------------|--|
| Organization name | CRUES- Community Reconstructive Upliftment and Educational Society |
| Registration number | |
| Address | Post Box 50, Nehrunagar, Budhikote road Bangarapet, Karnataka- 563 114 Tel. 9663619800, 09489081807 E-mail : crues7@yahoo.com , pnthambi@gmail.com |
| Website address | www.crues.org |
| Main contact person details | 1. Name: Mr. Premanand Thambi Position: General Secretary Email: pnthambi@gmail.com Tel: +91 9663619800 2. Name: Mr. Mr. Hansen Thambi Prem Position: Program Manager Email: htp.sen@gmail.com Tel: +91 9810169117 |
| Focal Area . | <ul style="list-style-type: none"> Water and Sanitation |

| SECTION 2: Basic Information about the Proposed Project | | |
|--|-----------------------------------|---|
| 2.1 | Project Title | Accessibility to toilet for Children. |
| 2.2 | Project Location | In CRUES Leela Family Home children at Bangarapet of Kolar district of Karnataka State of India. |
| 2.3 | Project Beneficiaries | 40 under privileged children from CRUES Leela Family Home , Bangarapet(Orphan, Semi-orphan, single parents, deserted parents etc) |
| 2.4 | Project Duration | 3 months |
| 2.5 | Project Cost (approximate) | Rs. 520,000/- = USD. 10,400/- |
| 3. Need :CRUES – Leela Family Home is fostering 40 under privileged children for their total development . Leela Family Home takes care of their education, Health, Shelter and Physical needs. Leela Family Home(LFH) is a unit of CRUES a registered charitable Organisation working for the underprivileged children. LFH is situated in a 2 acres campus and having | | |

TOILET COMPLEX FOR FAMILY HOME CHILDREN



necessary building for the children to stay, Study and dining. Sanitation requirement for the children are very minimal and children are facing difficulty for their freshens on time due to less toilet and bathing facility. Photograph is being enclosed for your verification.

Hence we request your contributions to build a new toilet complex with normal required facility for the children to use and have good sanitation and health.

The engineers building plan and estimate is also enclosed for the toilet complex .

Enclosures:

- i. Blue print of Toilet Block.**
- ii. Cost estimate of the toilet Block.**
- iii. Photographs**

TOILET COMPLEX FOR FAMILY HOME CHILDREN



Page 1 of 4

Name of work : Construction of Toilet block at CRUES, Bangarpet town, Bangarpet taluk.

Secretary : P.N. Thambi.

Est. cost Rs. 5.20 Lakhs

| Sl No. | Description of Item | Unit | Length | Breadth | Depth | Qty | Rate | Amount |
|--------|--|------|--------|---------|-------|--------------|---------|--------------|
| 1 | KSRB 2-2.2 : Earth work excavation for foundation of building, water supply, sanitary lines and electrical conduits either in pits or in trenches 1.5m and above in width, in hard soil not exceeding 1.5m. In depth including dressing the bottom and sides of pits and trenches, stacking the excavated soil clear from edges of excavation with lead upto 50m. after breaking of clods complete as per specifications. specification. No. KBS 2.1 (b) / 2.3.5 | | | | | | | |
| | All round walls | 1 | 25.44 | 0.75 | 0.75 | 14.31 | Cmtr | |
| | Vertical walls | 3 | 1.92 | 0.75 | 0.75 | 3.24 | Cmtr | |
| | | | | | | 17.55 | Cmtr | |
| | | | | | | | 211.00 | 3703 |
| 2 | KSRB 4-1.3 : Providing and laying in position plain cement concrete of mix M7.5 with OPC cement @ 180kgs, with 40mm and down size graded granite metal coarse aggregates @0.85cum and fine aggregates @ 0.57cum machine mixed, machine mixed, concrete laid in layers not exceeding 15 cms. thick, well compacted, in foundation and plinth, including cost of all materials, labour, HOM of machinery, curing complete as per specifications. Specification No. KBS 4.1, 4.2 | | | | | | | |
| | All round walls | 1 | 25.44 | 0.75 | 0.10 | 1.91 | Cmtr | |
| | Vertical walls | 3 | 1.92 | 0.75 | 0.10 | 0.43 | Cmtr | |
| | Flooring | 4 | 2.28 | 2.44 | 0.15 | 3.34 | Cmtr | |
| | | | | | | 5.68 | Cmtr | |
| | | | | | | | 3974.0 | 22564 |
| 3 | KSRB 5-2-23 : Providing and constructing granite /trap/ basalt size stone masonry in foundation with cement mortar 1:8, stone hammerdressed in courses not less than 20 cms high, bond stones at two m. apart in each course including cost of materials, labour, curing complete as per specifications. KBS 5.1.13 | | | | | | | |
| | All round walls | 1 | 25.44 | 0.60 | 0.60 | 9.16 | Cmtr | |
| | Vertical walls | 3 | 2.22 | 0.60 | 0.60 | 2.40 | Cmtr | |
| | | | | | | 11.56 | Cmtr | |
| | | | | | | | 3287.0 | 37985 |
| 4 | KSRB 5-3.3 : Providing and constructing granite /trap/ basalt size stone masonry in basement with cement mortar 1:6, edges of stones chiselled dressed in courses not less than 15 cms high, bond stones at two m. apart in each course including cost of materials, labour, curing complete as per specifications. KBS 5.1.13 | | | | | | | |
| | All round walls | 1 | 25.44 | 0.45 | 0.35 | 4.01 | Cmtr | |
| | Vertical walls | 3 | 2.37 | 0.45 | 0.35 | 1.12 | Cmtr | |
| | | | | | | 5.13 | Cmtr | |
| | | | | | | | 3914.00 | 20066 |
| 5 | KSRB 4.2.3 : Providing and laying in position reinforced cement concrete of mix M15 with OPC cement @ 240kgs, with 20mm and down size graded granite metal coarse aggregates @0.878cum and fine aggregates @ 0.459cum, machine mixed, concrete laid in layers not exceeding 15 cms thick, vibrated for all works in foundation plinth and ground floor level for roof slabs, staircase, lintels, retaining walls, return walls, walls (any thickness) including attached plasters, columns, piers, abutments, pillars, posts, struts, buttresses, string or lacing courses, parapets, coping, bed blocks, anchor blocks, plain window cills, fillets etc., including cost of all materials, labour, HOM of machinery, curing, complete as per specifications. Specification No. KBS 4.1, 4.6 | | | | | | | |
| | | 1 | 32.55 | 0.45 | 0.15 | 2.20 | Cmtr | |
| | | | | | | | 4507.0 | 9902 |
| 6 | KSRB 6-1.3 : Providing and constructing burnt brick masonry for basement and superstructure with approved quality of non-modular bricks of standard size of class designation 35 with cement mortar 1:6 including cost of materials, labour charges, scaffolding, curing complete as per specifications. Specification No. KBS 6.2 | | | | | | | |
| | All round walls | 1 | 26.36 | 0.23 | 3.00 | 18.19 | Cmtr | |
| | Vertical walls | 3 | 2.44 | 0.23 | 3.00 | 5.05 | Cmtr | |
| | parapet walls | 1 | 26.36 | 0.23 | 0.45 | 2.73 | Cmtr | |
| | Deductions ; | | | | | 25.97 | Cmtr | |

TOILET COMPLEX FOR FAMILY HOME CHILDREN



Page 2 of 4

| Sl No. | Description of Item | Unit | Length | Breadth | Depth | Qty | Rate | Amount |
|--------|--|------|--------|---------|-------|--------|------|---------|
| | Lintel | 1 | 33.68 | 0.23 | 0.10 | 0.77 | Cmtr | |
| | Doors | 4 | 0.75 | 0.23 | 2.10 | 1.45 | Cmtr | |
| | Ventilators | 4 | 0.90 | 0.23 | 0.60 | 0.50 | Cmtr | |
| | | | | | | 2.72 | Cmtr | |
| | | | | | | 23.25 | Cmtr | |
| | | | | | | | | 4733.00 |
| 7 | KSRB 4.2.2 : Providing and laying in position reinforced cement concrete of design mix M20 with OPC cement @ 320kgs, with 20mm and down size graded granite metal coarse aggregates @0.878cum and fine aggregates @ 0.459cum, with superplasticiser @3lts confirming to IS9103-1999 Reaffirmed-2008, machine mixed, concrete laid in layers not exceeding 15 cms thick, vibrated for all works in foundation plinth and ground floor level for roof slabs, staircase, lintels, retaining walls, return walls, walls (any thickness) including attached plasters, columns, piers, abutments, pillars, posts, struts, buttresses, string or lacing courses, parapets, coping, bed blocks, anchor blocks, plain window cills, fillets etc., including cost of all materials, labour, HOM of machinery, curing, complete as per specifications Specification No. KRS 4.1.4.6 | | | | | | | 110028 |
| | Roof | 1 | 10.43 | 3.35 | 0.13 | 4.54 | Cmtr | |
| | Lintel | 1 | 33.68 | 0.23 | 0.15 | 1.16 | Cmtr | |
| | | | | | | 5.70 | Cmtr | |
| | | | | | | | | 5222.00 |
| | | | | | | | | 29787 |
| 8 | Providing and fixing 30mm thick factory made rigid foam prelam panelled door shutters made from M.S.tube of 19x19 mm, 19 gauge for styles and 15x15 mm for top & bottom rails, covered with heat moulded prelaminated PVC C Channel of 5 mm thick sheet & 30x50 mm wide to form styles & 5 mm thick & 75 mm wide prelaminated PVC Sheets for top rail, lock rail & bottom rail on either side & 5mm thick, 20mm wide cross PVC sheet as gap insert for top rail & bottom rail, Panelling of 5 mm thick PVC sheet prelaminated on either side fitted in the M.S. frame, sealed to the styles & rails with PVC Designer beading on either side & joined together with solvent cement adhesive etc., Complete as per manufacturers specification & direction of Engineer-in-charge fixed to frames with 3 nos of 75mm. aluminium hinges with one side prelam | | | | | | | |
| | Doors | 4 | 0.75 | | 2.10 | 6.30 | Smtr | |
| | | | | | | | | 3908.00 |
| | | | | | | | | 24620 |
| 9 | Providing and fixing in position in cement concrete ventilators | | | | | | | |
| | Ventilators | 2 | | | | 2.00 | No.s | |
| | | | | | | | | 450.00 |
| | | | | | | | | 900 |
| 10 | KSRB 14.14-5: Providing Ceramic tiles of approved make,shade and size for flooring, treads of steps and landings laid on a bed of 12mm thick, cement mortar 1:3 mix, flush pointing with white cement using colour pigment , including cost of materials, labour, curing, complete as per specifications. Specification No. KBS _do_ for Ceramic Tiles of size 30x30cms | | | | | | | |
| | Urinals | 4 | 2.28 | 2.44 | | 22.25 | Smtr | |
| | | | | | | | | 881.00 |
| | | | | | | | | 19605 |
| 11 | KSRB 15-3.2 : Providing 12mm thick cement plaster in single coat with cement mortar 1:4, to brick masonry including rounding off corners wherever required smooth rendering, Providing and removing scaffolding, including cost of materials, labour, curing complete as per specifications. | | | | | | | |
| | Urinals | 4 | 9.44 | | 3.00 | 113.28 | Smtr | |
| | Out side | 1 | 26.36 | | 4.00 | 105.44 | Smtr | |
| | Deductions : | | | | | -8.30 | Smtr | |
| | | | | | | 210.42 | Smtr | |
| | | | | | | | | 149.00 |
| | | | | | | | | 31353 |
| 12 | KSRB 14-17.2 : Providing skirting, dado, rises of steps with colour glazed tiles on 10mm thick cement plaster 1:3 and jointed with white cement slurry over rough plaster surface (excluding cost of rough plastered surface which should be measured and paid separately) using glazed tiles of approved make and size including cost of materials, labour, complete as per specifications. | | | | | | | |
| | | 4 | 9.44 | | 2.10 | 79.30 | Smtr | |
| | | | | | | | | 874.00 |
| | | | | | | | | 69305 |

| Sl No. | Description of Item | Unit | Length | Breadth | Depth | Qty | Rate | Amount |
|--------|---|------|--------|---------|-------|-------------|---------|--------|
| 13 | KSRB 15-3.13 : Providing 12mm thick cement plaster in single coat with cement mortar 1:3, to ceiling including rounding off corners wherever required smooth rendering, Providing and removing scaffolding, including cost of materials, labour, curing complete as per specifications. | | | | | | | |
| | | 4 | 2.28 | 2.44 | | 22.25 Smtr | | |
| | | | | | | | 154.00 | 3427 |
| 14 | KSRB 15-16.1 : Providing and finishing external walls in two coats with waterproof cement paint of approved brand and shade to give an even shade after thoroughly brooming the surface to remove all dirt and loose powdered material, free from mortar drops and other foreign matter cost of materials, labour, complete as per specifications | | | | | 232.67 Smtr | | |
| | | | | | | | 74.00 | 17218 |
| 15 | KSRB 4.9.2 : Providing T.M.T steel reinforcement for R.C.C work including straightening, cutting, bending, hooking, placing in position, lapping and / or welding wherever required, tying with binding wire and anchoring to the adjoining members wherever necessary complete as per design (laps, hooks and wastage shall not be measured and paid) cost of materials, labour, HOM of machinery complete as per specifications. Specification No. KBS 4.6.3 | | | | | 5.70 Qntl | | |
| | | | | | | | 6899.00 | 39353 |
| 16 | KSRB 11-5 : Providing and fixing white vitreous china clay, water closet European type (Pedestal type, P-trap) with black solid plastic seat and lid, C.P brass hinges, rubber buffers, 10 litre low level, P.V.C flushing cistern (all are approved make) with fittings, C.I / M.S brackets, 40mm diameter flush bend with fittings and clamps, overflow arrangements with special and 25mm mosquito proof coupling of approved design, painting of fittings and brackets, cutting and making good the wall and floor wherever required, including cost of materials, labour complete as per specifications. Specification No. KBS 11 (P 79 I 12.5) | | | | | 4 No.s | | |
| | | | | | | | 4857.00 | 19428 |
| 17 | KSRB 12-8.1 : Constructing brick masonry inspection chamber 450x450mm, and 450mm depth, (clear inside dimension) for single pipeline, using table moulded non-modular bricks of class designation 50 in cement mortar 1:5, C.I cover with frame (light duty) 455x610mm internal dimensions, total weight of cover with frame to be not less than 38 kg (weight of cover 23kg and weight of frame 15kg) R.C.C. top slab with cement concrete 1:2:4 mix 20mm and downsize granite metal, foundation concrete 1:5:10 with 40mm and downsize granite metal inside plastering 12mm thick with cement mortar 1:3, finish smooth with a floating coat of cement on walls and bed concrete complete as per standard design including cost of materials, labour charges, curing complete as per specifications (P 82 I 11.50) | | | | | 3 No.s | | |
| | | | | | | | 4272.0 | 12816 |
| 18 | KSRB 13-8.2 : Providing and fixing to wall, ceiling and floor, low density polyethylene pipes 6.00 kgf/sq.cm working pressure 25mm outside diameter with special flange, compression type fittings, wall clips, making good the wall, ceiling and floor including cost of all materials,labour and HOM of equipments with all leads complete as per specifications. Specification No.KBS 13.2.15.1/13.9 (P 108 I 13.67) | | | | | 40.00 Rmtr | | |
| | | | | | | | 108.00 | 4320 |
| 19 | KSRB 13-8.3 : Providing and fixing to wall, ceiling and floor, low density polyethylene pipes 6.00 kgf/sq.cm working pressure 32mm outside diameter with special flange, compression type fittings, wall clips, making good the wall, ceiling and floor including cost of all materials,labour and HOM of equipments with all leads complete as per specifications. Specification No.KBS 13.2.15.1/13.9 (P 108 I 13.68) | | | | | 15.00 Rmtr | | |
| | | | | | | | 176.00 | 2640 |
| 20 | KSRB 13-6.3-2: Providing and fixing in position brass gate valve with C.I wheel of approved quality (screwed end) 20mm nominal bore including cost of all materials,labour and HOM of equipments with all leads complete as per specifications. Specification No.KBS 13.2.2/13.3 (P 104 I 13.33) | | | | | 2 No.s | | |
| | | | | | | | 404.0 | 808 |

TOILET COMPLEX FOR FAMILY HOME CHILDREN



Page 4 of 4

| Sl No. | Description of Item | Unit | Length | Breadth | Depth | Qty | Rate | Amount |
|--------|--|------|--------|---------|-------|-------|-----------------|--------|
| 21 | KSRB 13-6.5-2 : Providing and fixing unplasticised PVC connection pipe with brass union 20mm nominal bore 300mm length of PVC connection including cost of all materials labour and HOM of equipments with all leads complete as per specifications. (P 106 I 13.52) | | | | | 2 | No.s 221.0 | 442 |
| 22 | KSRB 13-1.2 : Providing and fixing to wall, ceiling and floor galvanised /mild steel tube 20mm dia nominal bore with fittings (medium grade weight 1.27 kg/mtr) B class including cost of all materials, labour charges, HOM of equipments and testing complete as per specifications. Specification No. KBS 13.2.14/13.8 (P 100 I 13.2) | | | | | 15 | Rmtr 212.0 | 3180 |
| 23 | KSRB 11-11.6 : Providing and fixing white vitreous china clay, angle back wah basin size 660x480mm with a single 15mm C.P brass pillar tap with C.I /M.S brackets, 32 mm C.P brass waste of standard pattern, painting of fittings and brackets, cutting and making good the wall and floor wherever required, including cost of materials, labour complete as per specifications. (P 90 I 12.28) | | | | | 4 | No.s 2878.0 | 11512 |
| 24 | KSRB 11-18-1.2: Providing and fixing sand cast iron soil waste and vent pipes 75mm dia. with spun yarn soaked in cement slurry and cement mortar 1:2 including cost of materials, labour, tesing complete as per specifications. KBS 11-1.11 (P 92 I 12.48) | | 2 | 2.50 | | 5.00 | Rmtr | |
| | | | 5 | 1.50 | | 7.50 | Rmtr | |
| | | | | | | 12.50 | Rmtr | |
| | | | | | | | 665.00 | 8313 |
| 25 | KSRB 12-1.4 : Providing and laying in position to required level of slope 100 mm internal diameter salt glazed stoneware pipes grade A and jointing with stiff mixture of cement mortar in proportion of 1:1, testing of pipes and joints, including cost of materials, labour complete as per specifications. Specification No. KBS 12.2.5/12.7 (P 93 I 11.1) | | 1 | 10.00 | | 10.00 | Rmtr 489.00 | 4890 |
| 26 | Providing and constructing dry rubble size stone masonry for soak pit | L.S. | | | | | | 5000 |
| 27 | Providing and fixing door frame with or without ventilatr made out of cold rolled steel section of the thickness 1.25mm formed into section of 60mmx105mm welded to form a rectangular door conforming to IS 513-1973 and phosphated and painted and with one coat of red oxide primer, two coat of approved enamel paints to the frame work with 4 no.s of hold fast of size 200x25x4mm fixed in cement concrete 1:3 of 20mm down size jelly and 4 no.s of ISI marked hinges 125mm long welded to the frame and fixed with shutter made out of honne wood styled and rails of 30mm thick withd panels of 12mm thick "Ecobaard" plain practice board exterior grade conforming to IS -3087 excluding the cost of fixtures but including labour charges for fixing of fixtures. the hollow portion of the frame to the filled with cc 1:2:4 of 20 mm down size jelly. Page no. 42 Item no. 7.22 | | 4 | 0.90 | 0.60 | 2.16 | Smtr 2200.00 | 4752 |
| 28 | Miscellaneous & rounding off | | | | | | | 2084 |
| | | | | | | | Total Rs. | 520000 |

(Rupees Five lakhs Twenty thousand only)

For, and on behalf of
A. PURUSHOTHAMA
 D.C.E
ATHAM CONSULTANTS
 Near Doom Light Circle,
 SOLAR -563 101.

TOILET COMPLEX FOR FAMILY HOME CHILDREN



Toilet Block at CRUES Bangarpet Town Bangarpet Taluk

Gen. Secretary P.N. Thambi

INDEX

D: Door: 0.75x2.10
V: Ventilator: 0.9x0.60

PLAN

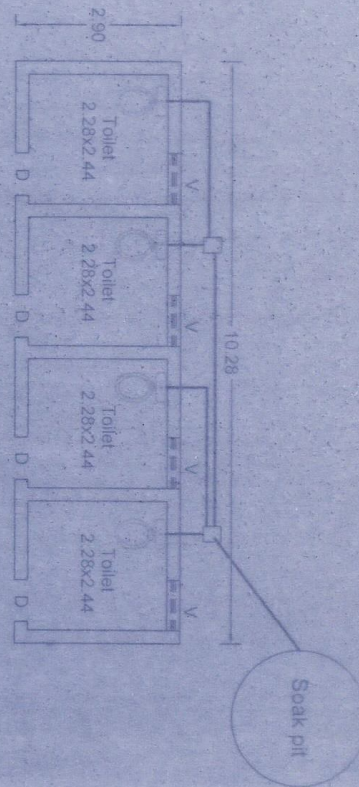

ELEVATION

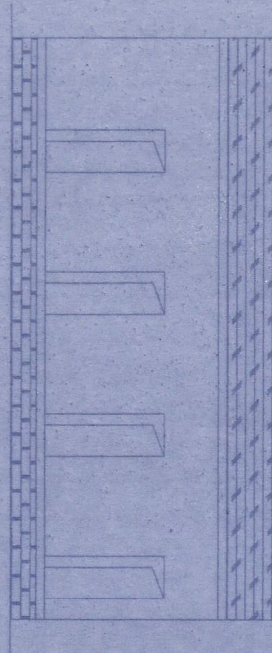

CROSS SECTION

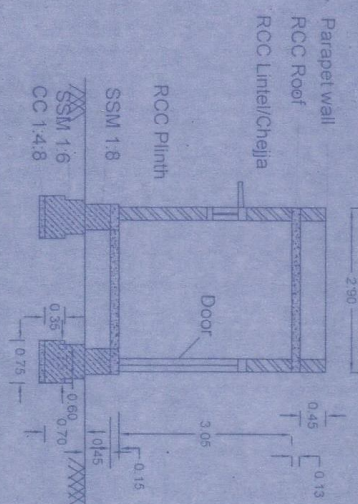

Handwritten signature
A. PURUSHOTHAMAN
D.C.E.
UTHAM CONSULTANTS
Near Doom Light Circle
COLAR 563 101