

Renovation Project of Refilwe God Parent Family Unit:

Esther-Hannah

Narrative and Picture Progress Report



Donor: La Trobe Foundation
Date of Report: 2 February 2010
Completed by: Annatjie Cilliers

Program Description: Refilwe God Parents Program

The God Parents Program currently provides a safe home for 51 children through 12 God Parent families. Each family has 4-6 children. Social workers from the Department of Social Development place the children through court orders with God Parents (foster parents) at Refilwe. This model allows for children to grow up in homes with families, receive an education and be loved in a secure and safe environment. This program is unique in that it addresses many of the deficiencies of traditional institutionalised child care by ensuring that children are cared for and supported in a family unit. The child remains part of the family and is not expected to leave Refilwe at the age of 18 years old. Operational support is about R6,700/ home / month.

Since 2005 Refilwe Community Project has been located on a property in Lanseria. Much development has taken place on the site to transform it into home for families. It also serves as an administrative hub for a wide range of community based programs and initiatives. Specifically, the homes that serve the God Parents Program were at one time dormitories (with no kitchens) for a resort that had existed on the property, but the buildings had since fallen into disrepair. These dormitories received renovations from 2005 to 2007 to bring them to an acceptable cottage for the children and parents to live in. However these 72m² cottages have bathrooms twice the size of the kitchens. The design is cramped for the large families that the units house. Currently, some of the cottages house up to 9 people.

Current Program Activities and Plans

Renovations: Refilwe Community Project recently introduced a renovation concept that would allow for parents and children to have separate bathrooms and make better use of the current kitchen space. This will allow the families a greater level of comfort and ease in their living situation as well as give parents a more defined private space. Three houses have already been completed at average cost of R60,000. A fourth is in progress and Refilwe is sourcing funding for the renovation project of remaining 8 family units. Please see the following house plans attached to this document:

- A – Original Family Unit
- C – Upgrade of Unit Model 2

Solar Energy: The Refilwe electricity bill is an average of R8000 per month. Refilwe could cut this amount by 30% per month should we install solar geysers for the family units. A solar geyser cost about R22,000. The installation of solar geysers fit with the strategic priority of Refilwe to become a more environmentally friendly place. Since 2005 Refilwe has been prioritising the natural environment and gradually has been implementing projects to save the natural environment. Testimony to this at Refilwe are the establishment of an organic fruit orchard, an indigenous tree nursery, in the process of saturating the site with indigenous trees and dry sanitation community latrines linked with a research project to recycle human waste.

The Support of the La Trobe Foundation: Esther-Hannah Family Unit

La Trobe Foundation has decided to support the God Parent Family Unit of Annatjie Cilliers and her foster children. Annatjie serves in the administration of Refilwe Community Project and has become a God Parent in February 2009. Her house is a home for teenage girls. The family calls their home: Esther-Hannah



Refilwe family (Esther-Hannah) who will be living in the house:

L-R: Malekgotla Baba (17 yrs), Annatjie Cilliers (40 yrs) (foster parent), Yonela Solomon (18 yrs), Norah Sibeko (17 yrs)

Progress Report on the Upgrade of Esther-Hannah

The renovations started on 15 January 2010 by a team of international volunteers who wanted to serve for two weeks at Refilwe Community Project. They were from various countries but all received missions training for 3 months in Davos, Swiss, before coming to South Africa for the practical part of their training. They will be working at various projects in South Africa for 3 months. The Refilwe Site Team continued with the renovations after the YWAM team had left.



YWAM team from Davos, Swiss, who started the upgrade on 15 Feb 2010

Picture Report

This is an account on the development of the renovations of Esther-Hannah family unit.

Before Pictures on 15 Jan 2009

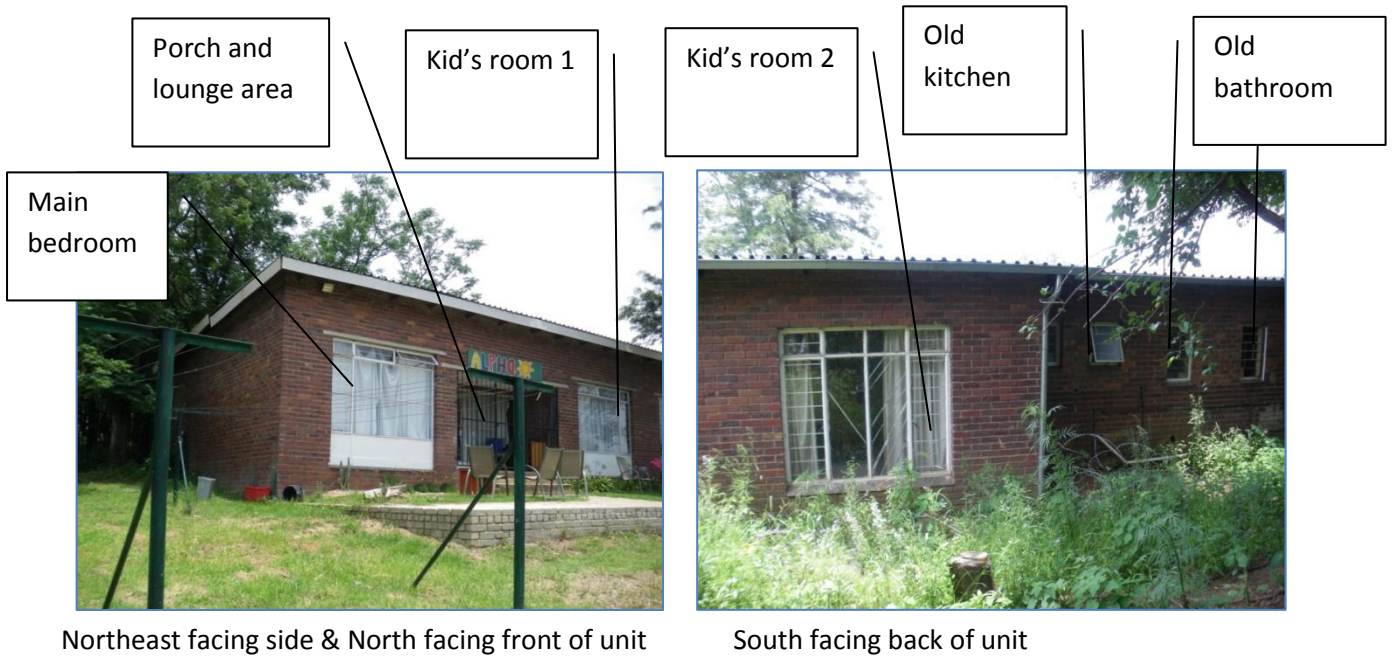

Old Bathroom with 2 toilets and 1 shower and a large area of unused space

Unused bath-
room space – to
become pantry /
store

Wall down for
bigger kitchen



Old Kitchen – 2x smaller than bathroom and directly connected with bathroom
This kitchen will become part of an open plan kitchen-lounge area

Wall will come
down for open plan
Kitchen-lounge

Kid's room 1

Lounge &
porch

Old entrance
to kitchen &
bathroom



Old lounge area

Old view from Kid's room 2



Old View from Kid's room 1

Renovation Period – 15 Feb to date



Kitchen-lounge, store, shower room and New entrance to Kid's Room 2

Main bedroom and en suite



Savings and Contributions to date:

Donations:

- La Trobe Foundation: R23 000 for renovation costs and house signs
- Refilwe: R10 000 for renovation costs
- Geberit: Cisterns and Actuators for small shower and bath rooms (R2334)
- Marius Erasmus: From Messaris Architects – floor plan with new changes and details